

euroseats

UPRIGHT BIKE

Item No. 13.FIE.002

INSTALLATION GUIDE

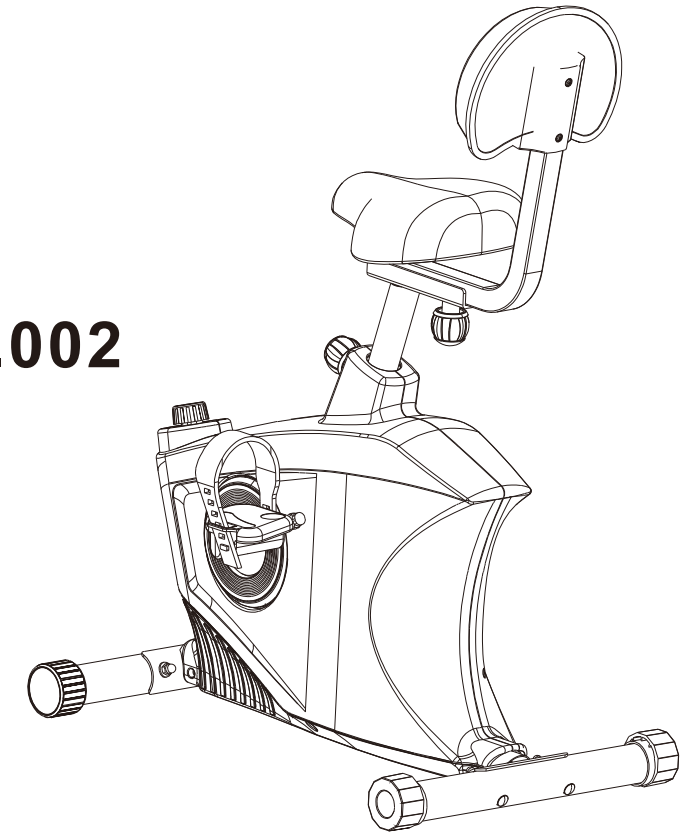

CAUTION

Please read all instructions carefully before using this product. Retain this manual for future reference. The specifications of this product may vary slightly from the illustrations and are subject to change without notice.

1. Make sure you read and fully understand this instruction manual.
2. It is the user's responsibility to read and understand all potential hazards of this exercise equipment.
3. Consult a physician before you begin a new exercise program. If you should experience pain, or you feel faint, short of breath or dizzy, stop exercising and consult a physician. Incorrect or excessive use of this machine can result in injury.
4. Your exercise bike should be operated on a stable, level surface.
5. Mount and dismount your exercise bike carefully.
6. Keep loose clothing, untied shoelaces, jewelry and towels away from the bike pedals.
7. This machine is not a toy. Keep children away from this exercise bike, especially while in use. Children should be taught to never put their fingers near any moving parts on this machine. Minors should not use this product, since it is built and intended for adults.
8. Remain seated while using bike - do not stand on pedals.
9. Maximum weight capacity of this bike is 242 lbs (110 kg).

Ignoring the warnings in this manual could lead to hazardous situations that might result in serious injury or death.

PACKAGE INCLUDED:

ACCESSORY PACKAGE LIST

1. 

M8x65 mm bolt
(4 PCS)
2. 

Φ 8 washers
(4 PCS)
3. 

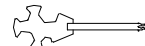
M8 nuts
(4 PCS)
4. 

Screwdriver
10, 13, 15, 17 (1 PC)
5. 









Socket wrench
(1 PC)
6. 

Hex key 5x5mm
(1 PC)
7. 

Φ 8.5 washers
(1 PC)
8. 

spring washer
(4 PCS)

PARTS LIST

- A. 
- B. 
- C. 
- D. 
- E. 
- F. 
- G. 
- H. 
- I. 

MAIN PARTS DIAGRAM

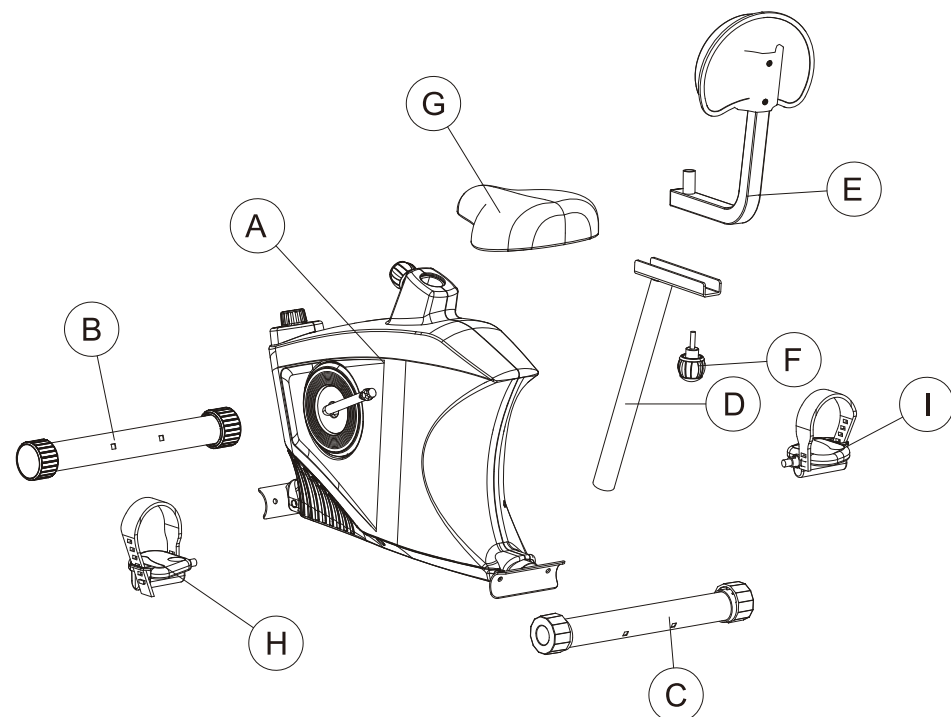

ASSEMBLY STEP 1

Set the cart (A) on the floor. Attach the front stabilizer (B) to the cart (A) using two head bolts (1) two washers (2), two spring washers (8) with two nuts (3). Use the enclosed screwdriver (4). Next, attach the rear stabilizer (C) to the cart using two head bolts (1) and two washers (2), two spring washers (8) with two nuts (3) as well.

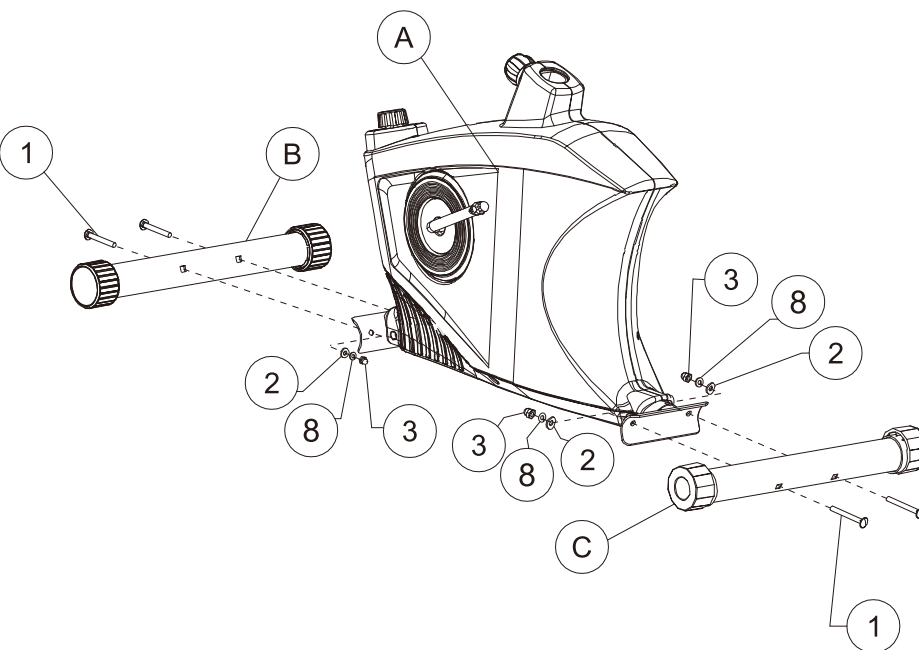

ASSEMBLY STEP 2

Loosen the seat height adjustment knob by turning it, then pull it in order to slide the seat frame (D) into the base of the bike (A); adjust the seat height then release knob. When you hear a click, the spring-loaded knob is supporting the seat frame at the selected height. Now tighten knob. Next, attach seat cushion assembly (E) to the seat frame (D), then lock assembly (E) in place with the seat cushion adjustment knob (F) equipped with washer (7).

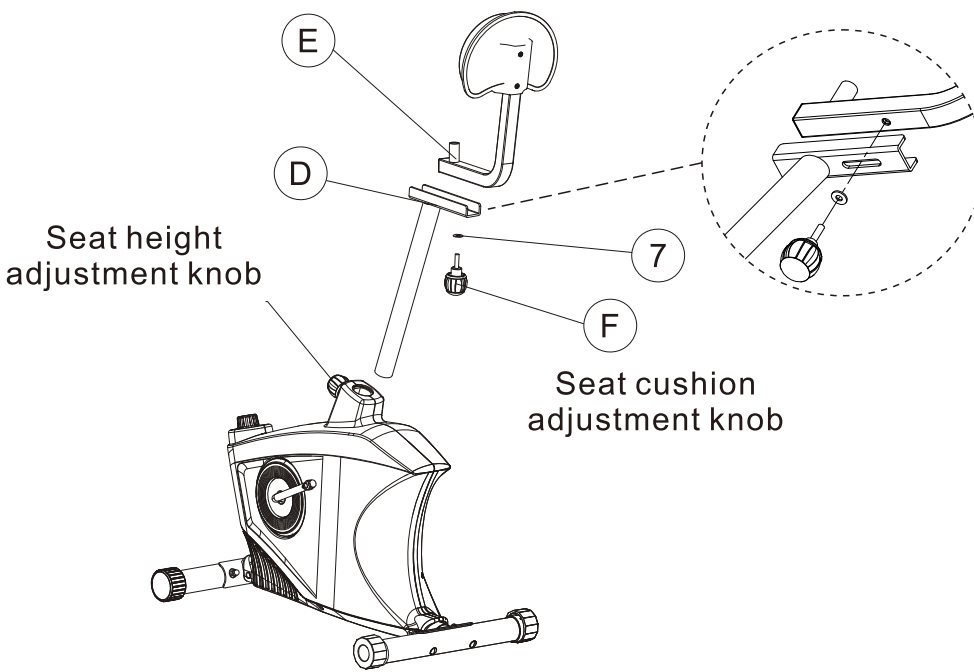

ASSEMBLY STEP 3

Take cushion out of shipping bag, then attach the seat cushion (G) to the seat frame. Now lock the seat cushion firmly in place with the socket spanner (5) and allen key (6).

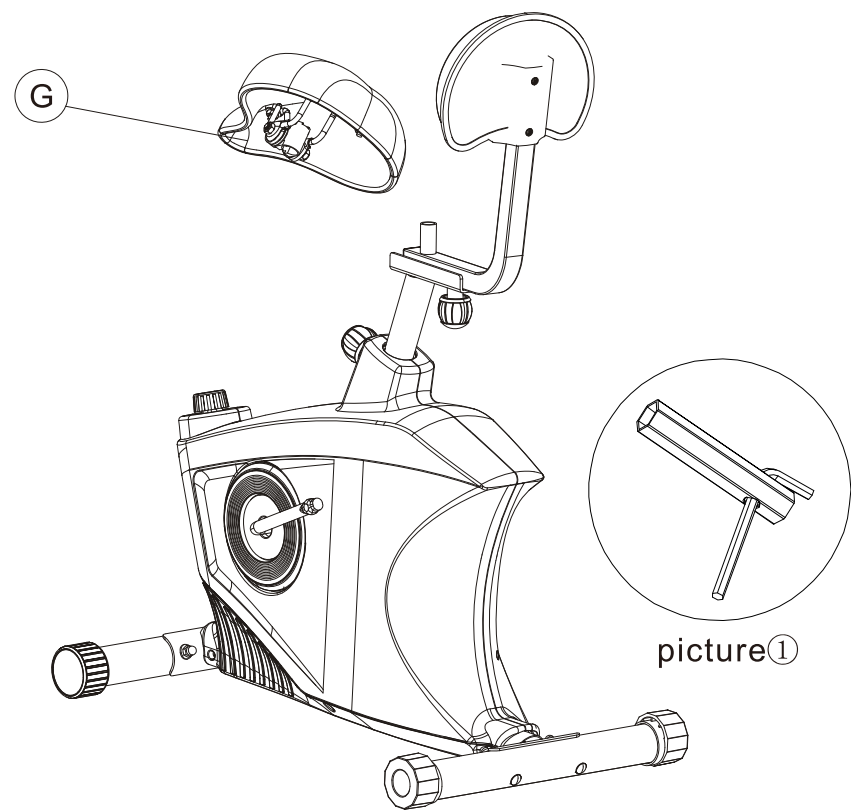

ASSEMBLY STEP 4

Assemble the pedals as shown in the pictures below.

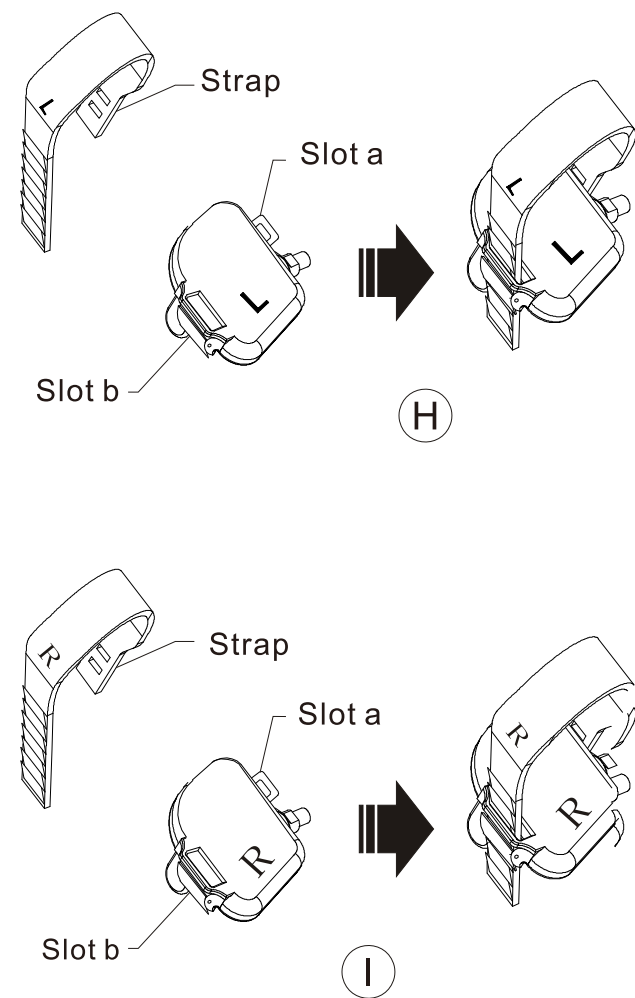

⚠ Note: The left and right pedals are different and must be installed on their matching sides of the bike.

ASSEMBLY STEP 5

Install the pedals (H) (I) on the crank legs and lock them firmly with the wrench side of the wrench / screwdriver (4).

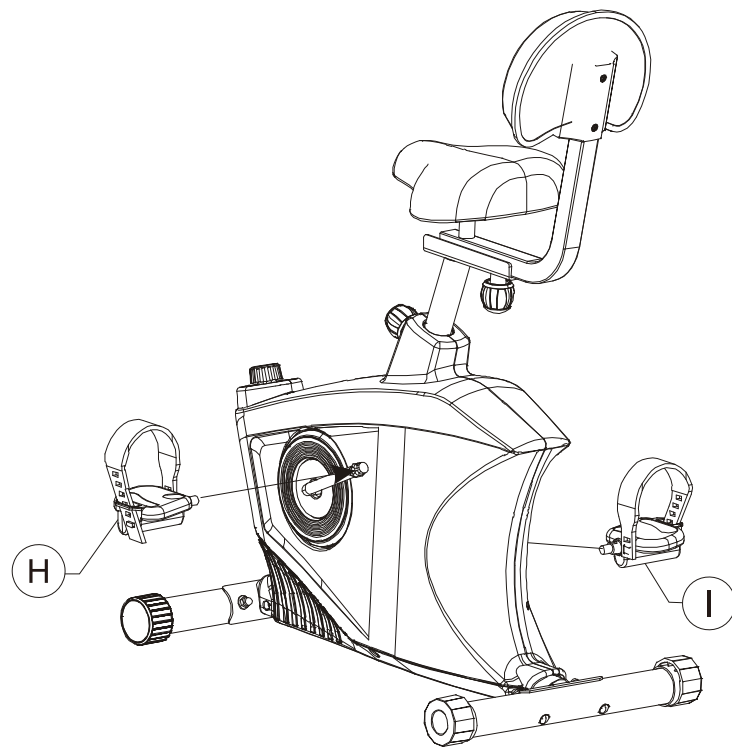

FINAL INSTALLATION STEPS

